

SC601

Single Point Load Cell

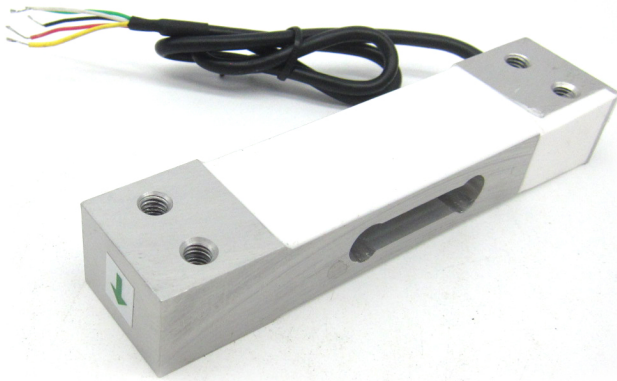

Application: Electronic scale, platform scale, pricing scale, force test.

Specification:

Capacity	3kg- 120kg
Rated output	2.0 ± 0.1 mV/V
Accuracy class	C2:0.03%F·S C3:0.02%F·S
Comprehensive error	$\pm 0.02\%$ F·S
Creep	0.02%F·S /10min
Non-linearity	0.02%F·S
Hysteresis error	± 0.2 %F·S
Repeatability	0.02%F·S
Zero balance	$\pm 1\%$ F·S
Temp. effect on sensitivity	0.02%F·S/10° C
Temp. effect on zero	0.03%F·S/10° C
Input resistance	405 ± 10 Ω
Output resistance	350 ± 3 Ω
Insulation resistance	≥ 5000 M Ω (100VDC)
Excitation voltage	9~12 VDC
Compensated temp. range	-10° C ~+40° C
Operating temp. range	-20° C ~+60° C
Safe overload	120 %F·S
Ultimate overload	150%F·S
Load cell material	Aluminum alloy

Size: mm

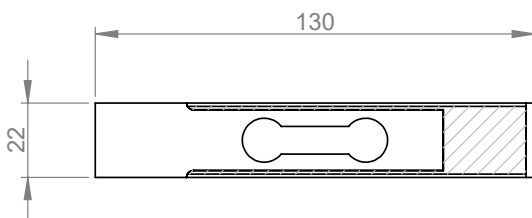
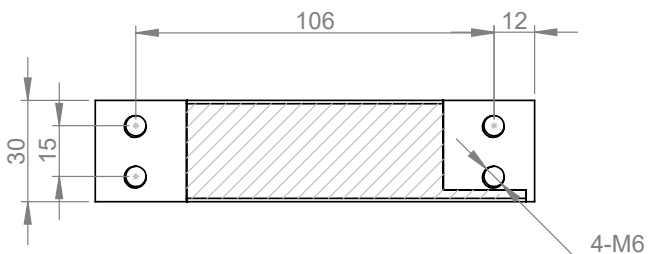

Wiring

