

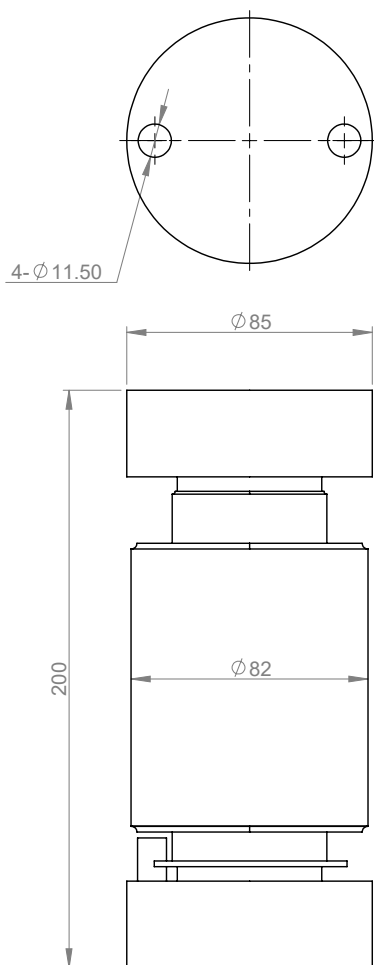

Size: mm



SC4818

Column Type Load Cell



Application: Electronic scale, truck scale.

Specification:

Capacity	20T, 30T, 40T
Rated output	2.0±0.004 mV/V
Accuracy class	C1: 0.05%F·S C2: 0.03%F·S
Combined error	≤± 0.020% F·S
Creep	0.016% F·S/30min
Temp. effect on sensitivity	0.0011% F·S/° C
Temp. effect on zero	0.018% F·S/° C
Zero balance	±1.0% F·S
Input resistance	725±5 Ω
Output resistance	702±4 Ω
Insulation resistance	5000 MΩ(50V)
Excitation voltage	5~15V
Compensated temp. range	-10~+40° C
Operating temp. range	-40~+80° C
Safe overload	150% F·S
Ultimate overload	200% F·S
Load cell material	Alloy steel Stainless steel
Connecting cable	Φ5.7x12m Φ5.7x16m

Wiring

