

SC635

Micro Type Load Cell



Application: Kitchen scale, body scale, baby scale, platform scale, pricing scale, force test equipment.

Specification:

Capacity	1kg-50kg
Rated output	$1.0 \pm 0.2\text{mV/V}$
Accuracy	0.05%F-S
Comprehensive error	0.05%F-S
Creep	$\pm 0.1\%F-S/3\text{min}$
Non-linearity	$\pm 0.05\%F-S$
Hysteresis error	$\pm 0.05\%F-S$
Repeatability	$\pm 0.05\%F-S$
Temp. effect on sensitivity	$0.1\%F-S/10^\circ\text{C}$
Temp. effect on zero	$0.2\%F-S/10^\circ\text{C}$
Zero output	$\pm 0.3\text{mV/V}$
Input resistance	$1050 \pm 10 \Omega$
Output resistance	$1000 \pm 10 \Omega$
Insulation resistance	$\geq 1000 \text{ M}\Omega$
Temp. compensated range	$-10\sim+40^\circ\text{C}$
Excitation voltage	3~10 VDC
Ultimate overload	150%F-S
Load cell material	Aluminum alloy
Four corner error	0.1%F-S
Connecting cable	$\Phi 0.8 \times 220\text{mm}$
Unit weight	25 g/unit
Package	500 units / carton

Size: mm

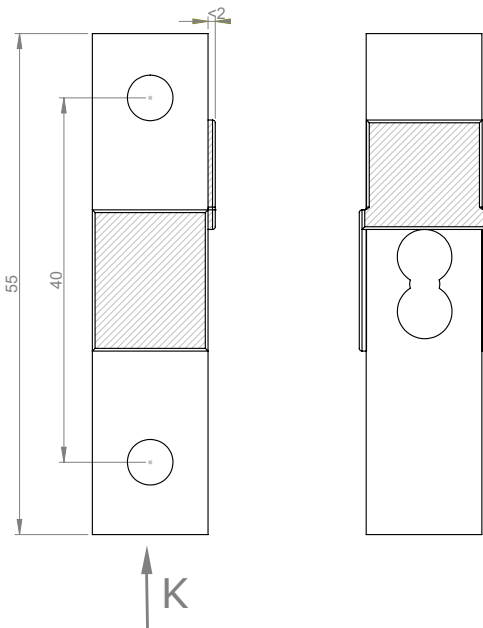
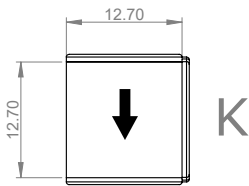

Wiring

